



APLIN MARTIN

ENGINEERING ARCHITECTURE PLANNING SURVEYING

EGBC Permit to Practice Number #1001018
Aplin & Martin Consultants Ltd.
 #201 - 12448 82 Avenue, Surrey, BC, Canada V3W 3E9
 Tel: (604) 597-9058, Fax: (604) 597-9061, Email: general@aplinmartin.com



NEW WESTMINSTER

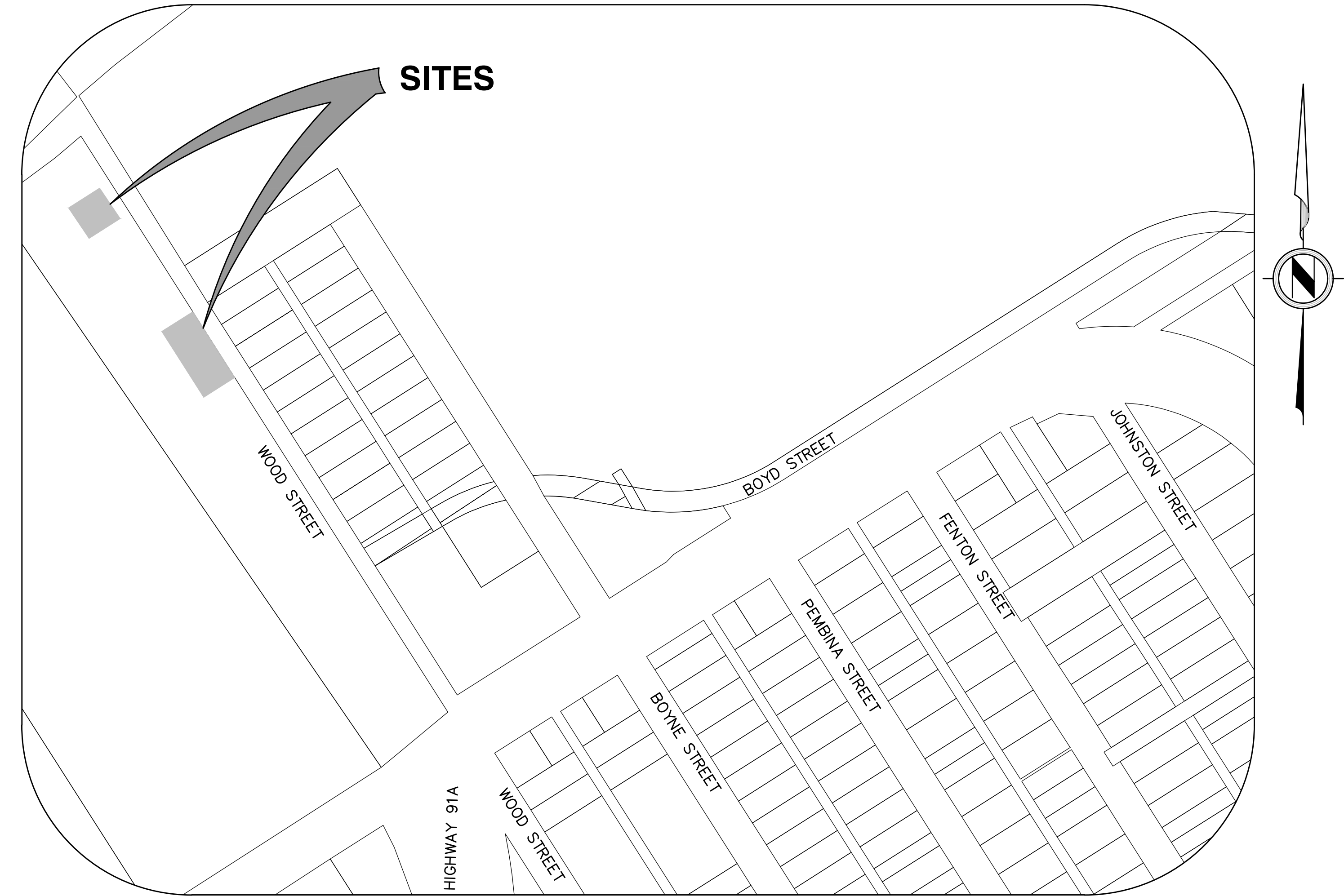

SITE LIMIT AND LOCATON
N.T.S.

CLIENT: **CITY OF NEW WESTMINSTER**
 511 ROYAL AVENUE, NEW WESTMINSTER, BC V3L 1H9
 PH: 604-521-3711

PROJECT: **WOOD STREET CANAL REHABILITATION**

DRAWING INDEX

Sheet Number	Description	Sheet Title
19-030-00	STORM WORKS	COVER SHEET AND SITE LOCATION
19-030-01	STORM WORKS	STA 2+000 TO 2+300
19-030-02	STORM WORKS	STA 2+300 TO 2+420
19-030-03	STORM WORKS	SECTION DETAILS

APLIN & MARTIN PROJECT No. 19-030
CITY OF NEW WESTMINSTER CONTRACT NO. NWIT-21-28

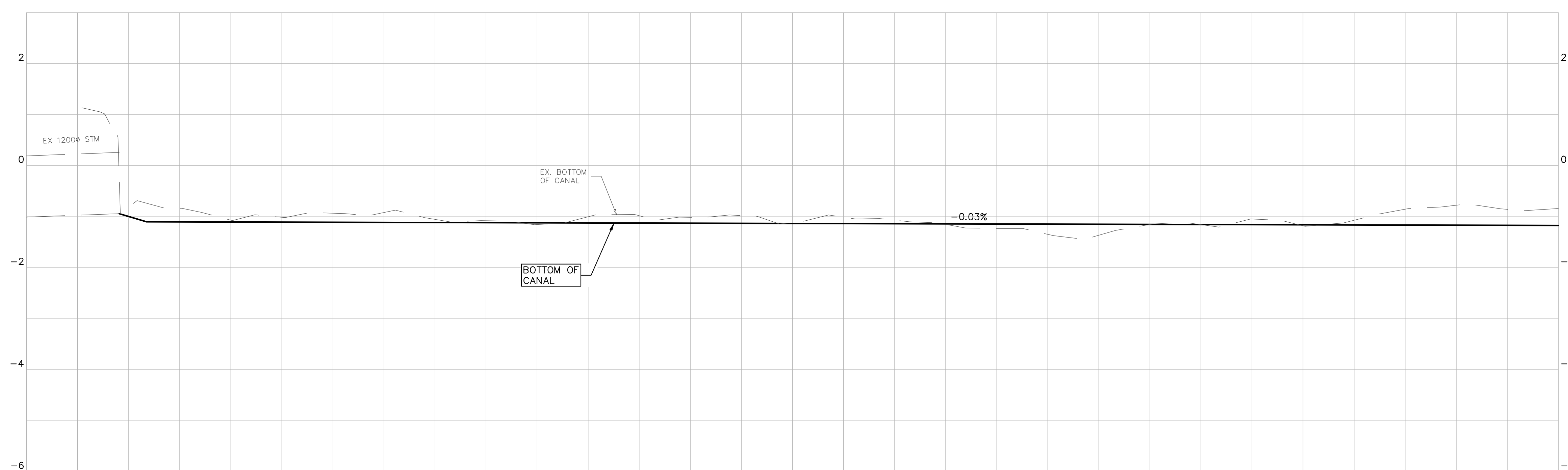
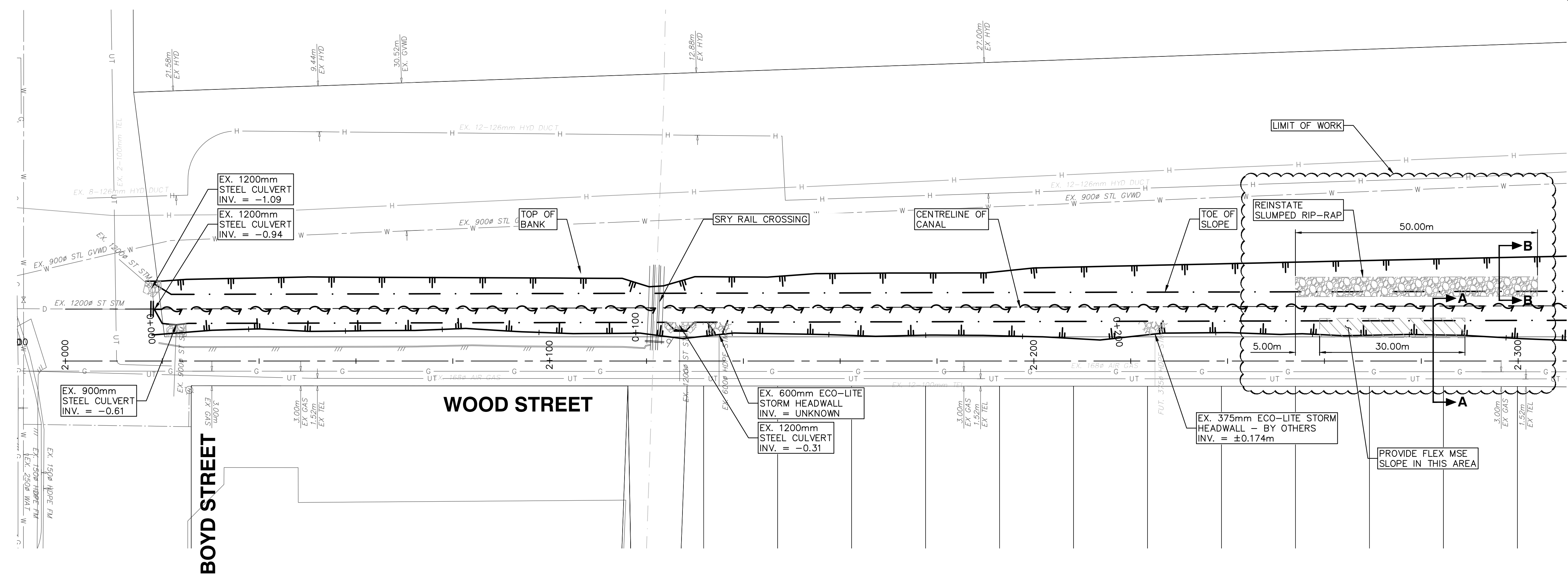
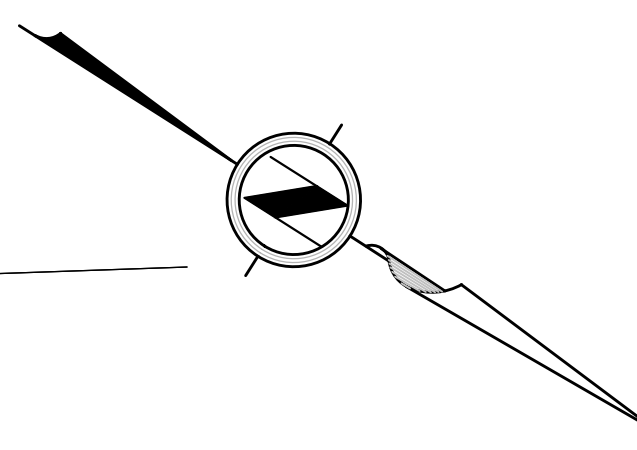

CHAINAGE	EXISTING ELEVATION	PROPOSED ELEVATION
2+000	-0.81	-1.00
2+020	-1.07	-1.10
2+040	-0.93	-1.11
2+060	-1.05	-1.11
2+080	-1.15	-1.12
2+100	-0.98	-1.13
2+120	-0.98	-1.13
2+140	-1.01	-1.14
2+160	-1.15	-1.14
2+180	-1.35	-1.15
2+200	-1.15	-1.15
2+220	-1.05	-1.16
2+240	-0.78	-1.17
2+260	-0.84	-1.17
2+280	-0.84	-1.17
2+300	-0.84	-1.17

LEGAL DESCRIPTION:			
SURVEY BENCHMARK		SCALE FACTOR:	
MON: OCM 89H6027	N:	E:	ELEV: 1.118m
REV.	DATE	DESCRIPTION	APP
1	OCT. 20/2021	ISSUED FOR TENDER	MEC

CONSULTANT

APLIN MARTIN
ENGINEERING ARCHITECTURE PLANNING SURVEYING

201 - 12448 82 Avenue, Surrey, B.C. Canada V3W 3E9
Tel: (604) 597-9058, Fax: (604) 597-9061, Email: general@aplinmartin.com

CLIENT:

CITY OF NEW WESTMINSTER
511 ROYAL AVENUE, NEW WESTMINSTER, BC V3L 1H9
PH. 604-521-3711

TITLE:

WOOD STREET CANAL REHABILITATION
STA 2+000 TO 2+300

SCALE: HORZ. 1: 500
VERT. 1: 50

DESIGNED: NAP
DRAWN: NAP
REVIEWED: DEW

DRAWING DATE: APRIL 2019

CONSULTANT PROJ. NO.: **19-030**

DWG. NO.: **01 OF 03**

REV. **1**

CITY PROJECT NUMBER: **NWIT-21-28**

DRAWING TYPE: **STORM WORKS**

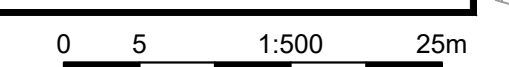

FILE LOCATION: \\V:\2019\19-030\DWG\OFFSITE\PRODUCTION\19-030 - STORM WORKS\DWG - LAST PLOTTED ON: Monday, November 1, 2021 2:36:44 PM

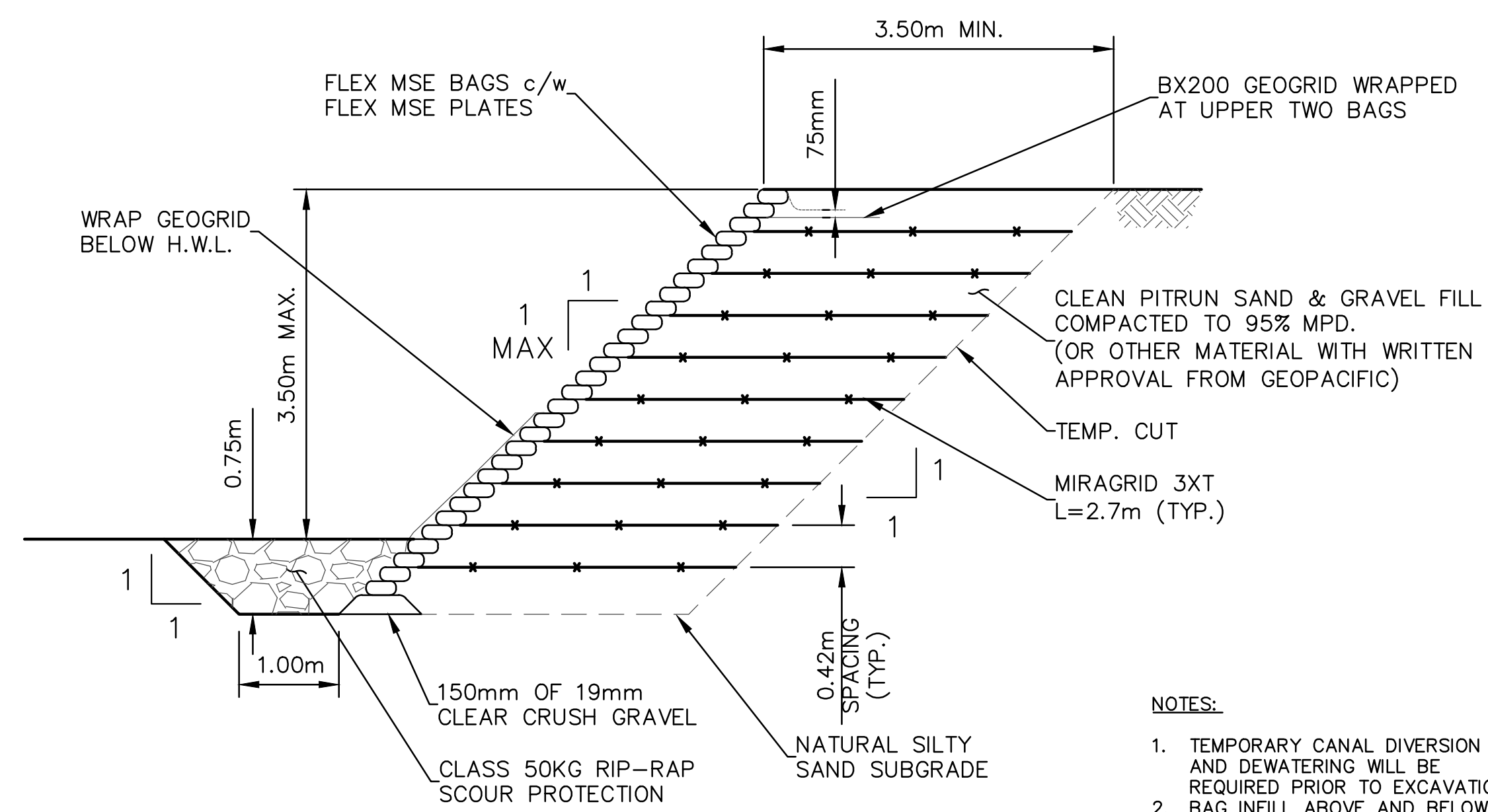

**WOOD STREET CANAL
REINFORCED SOIL SLOPE DETAIL
SECTION A-A**
NTS

NOTES:

1. TEMPORARY CANAL DIVERSION AND DEWATERING WILL BE REQUIRED PRIOR TO EXCAVATION.
2. BAG INFILL ABOVE AND BELOW WATER LEVEL PER FLEX MSE.

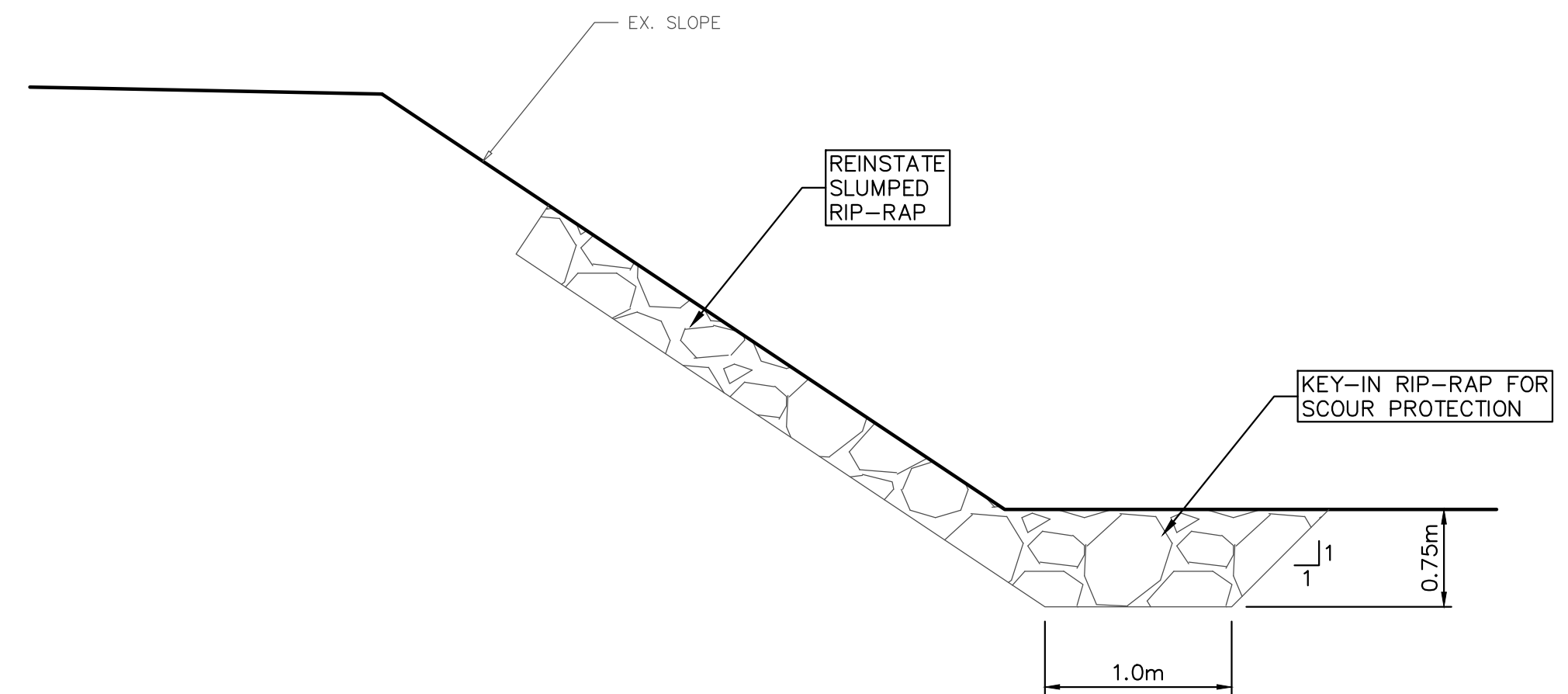

**WOOD STREET CANAL - WEST SIDE SLUMPS
SECTION B-B**
NTS

LEGAL DESCRIPTION:			
SURVEY BENCHMARK MON: OCM 89H6027		SCALE FACTOR: ELEV: 1.118m	
REV.	DATE	DESCRIPTION	APP
1	OCT. 20/2021	ISSUED FOR TENDER	MEC

CONSULTANT



APLIN MARTIN
ENGINEERING ARCHITECTURE PLANNING SURVEYING

201 - 12448 82 Avenue, Surrey, B.C. Canada V3W 3E9
Tel: (604) 597-9058, Fax: (604) 597-9061, Email: general@aplinmartin.com

CLIENT:

CITY OF NEW WESTMINSTER
511 ROYAL AVENUE, NEW WESTMINSTER, BC V3L 1H9
PH. 604-521-3711

TITLE:
**WOOD STREET CANAL
REHABILITATION**

SCALE: HORIZ. 1: 500
VERT. 1: 50

DESIGNED:
NAP

DRAWN:
NAP

REVIEWED:
DEW

DRAWING DATE
APRIL 2019

CONSULTANT PROJ. NO:
19-030

DWG. NO.
03 OF 03

REV.
1

CITY PROJECT NUMBER
NWIT-21-28

DRAWING TYPE:
SECTION DETAILS