



NEW WESTMINSTER

May 19, 2015

**ADDENDUM #1
NWRFP-15-12
Engineering Services,
Twelfth Street Storm Sewer Outfall Reconstruction
New Westminster, BC**

This addendum modifies the Request for Proposal only as noted:

ADDITIONAL INFORMATION

Please see attached reference document:

1. As constructed drawing for eh storm sewer out fall
2. Two (2) pictures of the outfall with the Tide flex (installed approximately ten years ago)
the outfall is visible at a .3 m tide

Please acknowledge this addendum in your Proposal.

END OF ADDENDUM #1

Yours truly,

Heather M. Rossi

Intermediate Buyer

email: hrossi@newwestcity.ca

REF. PLAN 13939

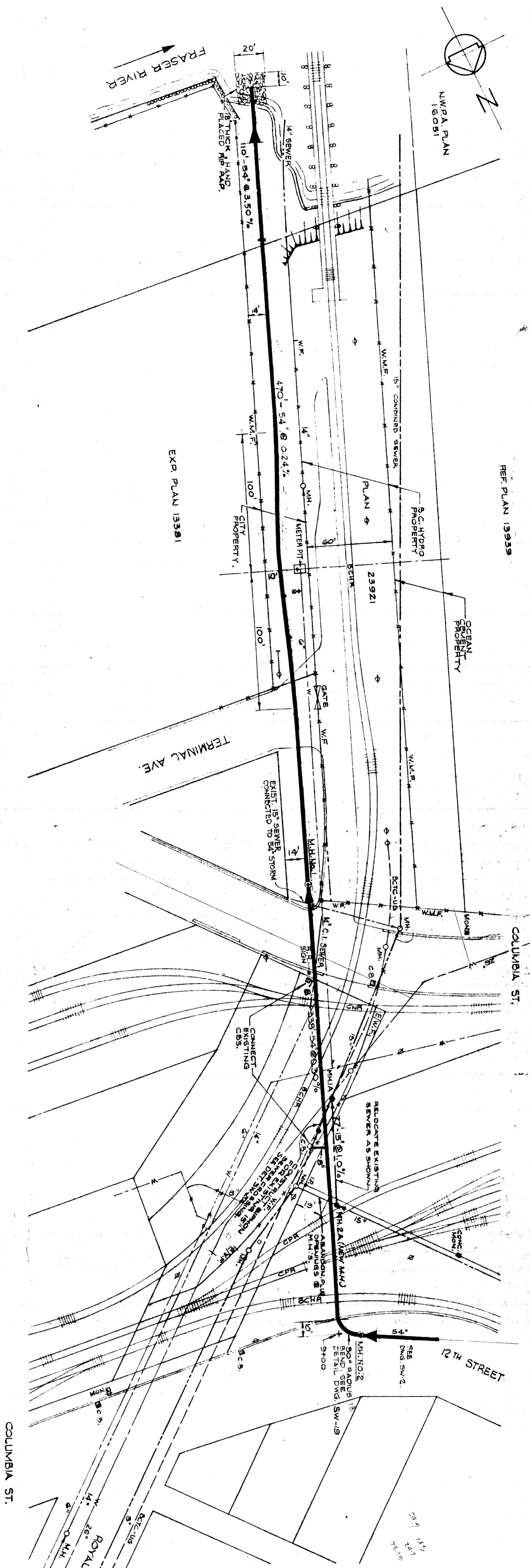

SYMBOL	DESCRIPTION
	NEW PROPOSED STORM SEWER - MANHOLE NO. 1
	EXIST. CATCH BASIN WITH NEW 8" & LEAD
	EXIST. MANHOLE WITH NEW 10" & LEAD
	EXIST. COMBINED SEWER AND MANHOLE
	B.C. HYDRO UNDERGROUND
	UTILITY POLE
	WATER MAIN
	WATER HYDRANT AND VALVE
	GAS MAIN AND VALVE
	PROPERTY LINE
	CURB AND GUTTER
	WIRE FENCE
	WIRE MESH FENCE
	RAILWAY TRACKS

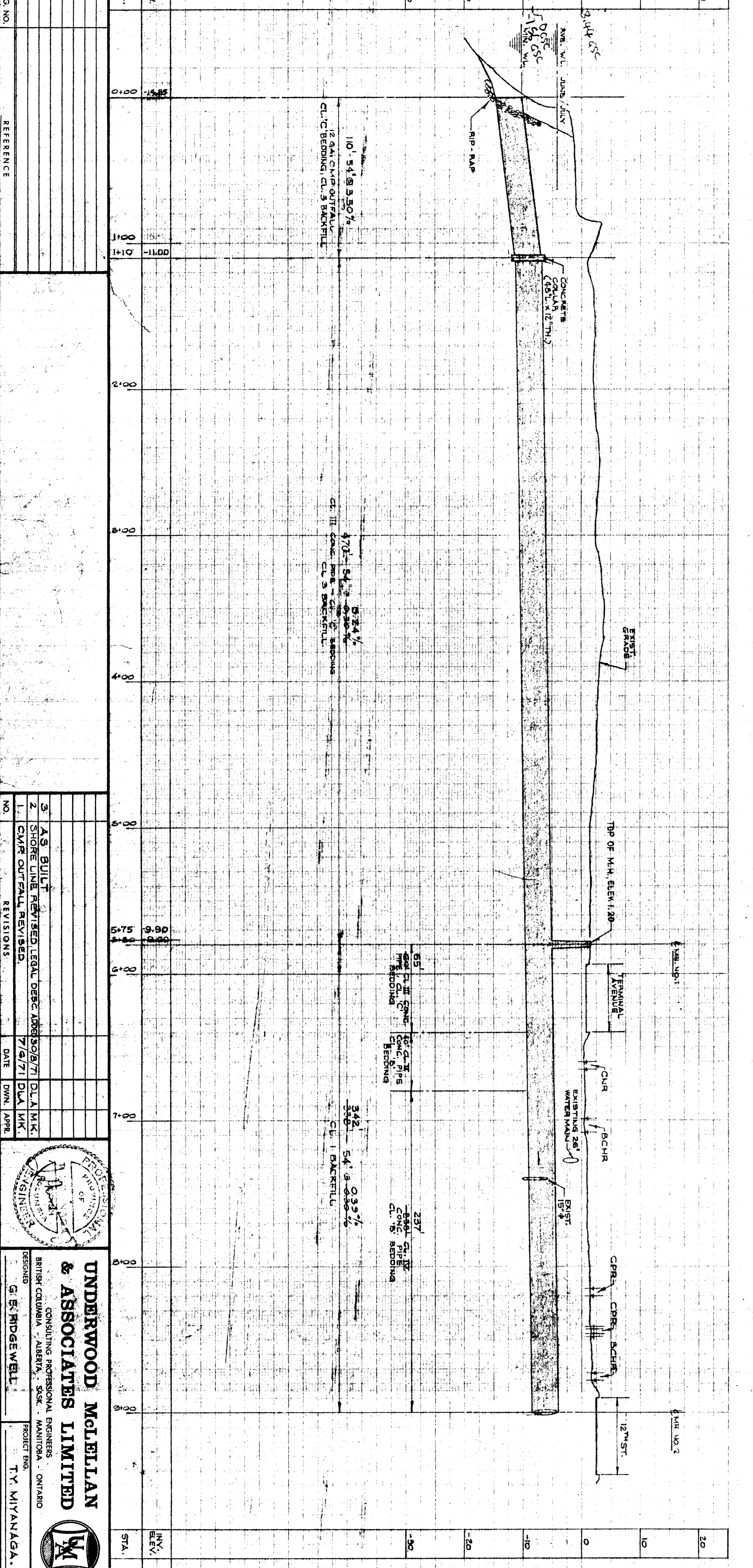

NOTE
 1. SEE DRAWING TO CITY DEPT. TO OBTAIN GEODETIC ELEM. AND ELEV. DATA.
 2. ELEV. TOP OF SPIGOLE OF HYDRAULIC NORTH CORNER OF QUEEN'S AVE. AND TWELFTH STREET ELEV. 4.28'

LEGEND

NO.	REVISIONS	DATE	DWN.	APPR.
1	CMR OUTFALL REVISED.	7/5/71	DJA	MLK
2	SHORE LINE REVISED LEGAL DEBC ADDRESS/ST/	7/5/71	DJA	MLK
3	AS BUILT			

UNDERWOOD McLELLAN & ASSOCIATES LIMITED
 CONSULTING PROFESSIONAL ENGINEERS
 BRITISH COLUMBIA - ALBERTA - SASK. - MANITOBA - ONTARIO

DESIGNED: G. S. RIDGEWELL
 PROJECT ENG. T. Y. MIYANAGA

CITY OF NEW WESTMINSTER
 CENTRAL AREA STORM SEWER
 STAGE I
 TWELFTH STREET TO RIVER

SCALE: 1" = 40' HORIZ.
 1" = 4' VERT.

DRAWN: E. S.
 DATE: MAY 1970

JOB NO. 1102-1153-01
 DWG. NO. SW#1
 REV. 3



