



CORPORATION OF THE CITY OF NEW WESTMINSTER

September 15, 2010

**ADDENDUM #3
NWRFP-10-23
Structural Design Services, Addition and Renovation
Queensborough Community Centre
New Westminster, BC**

This addendum modifies the Request for Proposal only as noted:

TABLE OF CONTENTS

<ADD> Appendix F – Spatial Relationship Floor Plan (2 pages following)

<ADD> Appendix G – Area Calculations (2 pages following)

13.0 DELIVERABLES AND SCHEDULE

13.2 <CHANGE TO READ> “The City requires the project to be completed no later than December 31, 2013 in accordance with funding stipulations. The aforementioned dates for substantial completion August 1, 2012 and official opening September 1, 2012 are the preferred and anticipated dates for project completion.”

Please acknowledge this addendum in your Proposal.

END OF ADDENDUM #3

Yours truly,

A handwritten signature in blue ink that reads "Heather M. Rossi".

Heather M. Rossi
Intermediate Buyer
email: hrossi@newwestcity.ca

APPENDIX F

Spatial Relationship Floor Plan

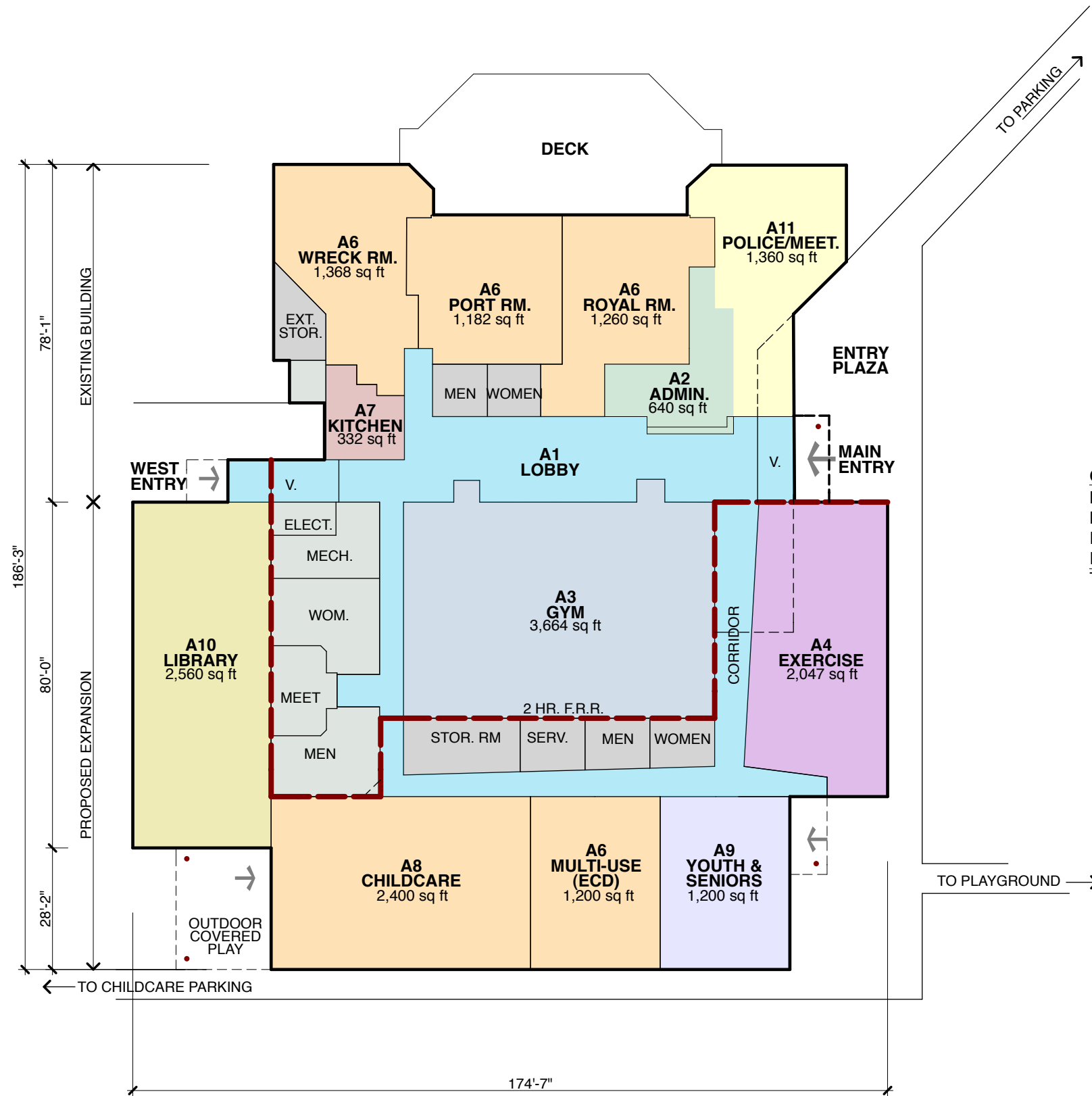

GROSS FLOOR AREAS:

MAJOR EXPANSION MAIN FLR:	11,495 sq ft
MINOR EXPANSION:	517 sq ft
RENOVATION:	2,443 sq ft
REMAINING EXISTING BLDG.	11,562 sq ft
TOTAL	26,017 sq ft

6		
5	REVISED	MAR. 19/10
4	REVISED	MAR. 2/10
3	REVISED	JAN. 25/10
2	PRELIMINARY	JAN. 15/10
1	PRELIMINARY	OCT. 28/09

All plans, sketches, drawings, graphic representations and specifications prepared by David Norman Architect Inc. are instruments of service for carrying out a project. David Norman Architect Inc. retains copyright in these plans, sketches, drawings, graphic representations and specifications, which may not be used for any other project without the written consent of David Norman Architect Inc.

Examine the drawings carefully before commencing the Work. Report discrepancies, if any, to the Architect and obtain clarification or additional instructions before proceeding with that part of the Work.

Do not commence the Work unless the drawing is issued for Construction

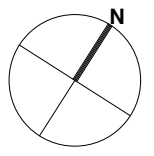

PROJECT:
QUEENSBOROUGH COMMUNITY CENTRE
SCHEMATIC DESIGN STUDY
920 EWEN AVE.
NEW WESTMINSTER, B.C.

DRAWING:
SCHEMATIC DESIGN
RENOVATION/ EXPANSION OPTION

DRAWN BY: S.C.	CHECKED BY:
DATE: OCT. 21, 2009	SCALE: 1" = 30'-0"
PROJECT NO.: 2922	DRAWING NO.:

MAIN FLOOR
ELEV. 1.5m

SK 1.1
R3

APPENDIX G

Area Calculations

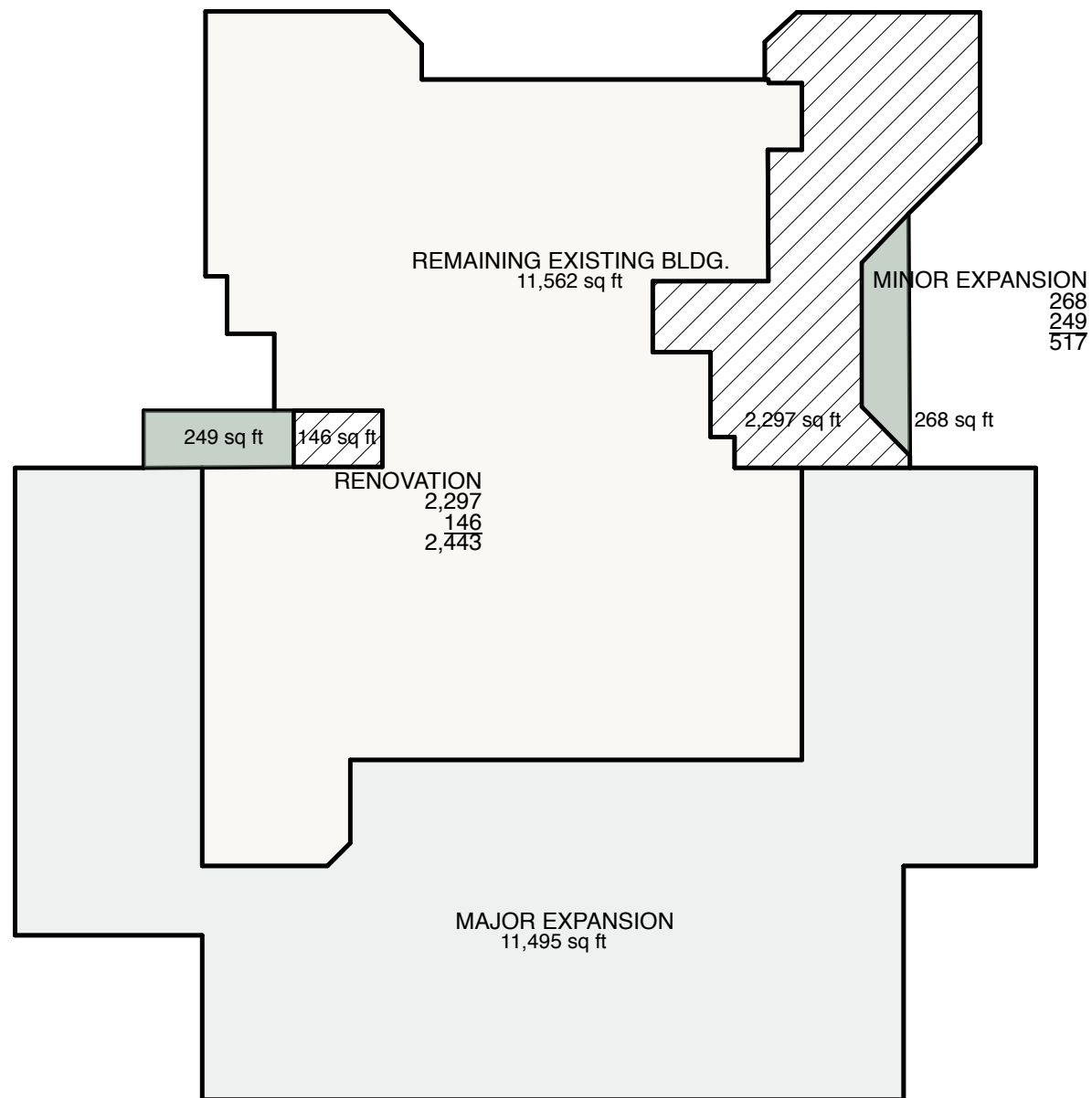

GROSS FLOOR AREAS:

MAJOR EXPANSION MAIN FLR:	11,495 sq ft
MINOR EXPANSION:	517 sq ft
RENOVATION:	2,443 sq ft
REMAINING EXISTING BLDG.	11,562 sq ft
TOTAL	26,017 sq ft

6		
5		
4		
3		
2		
1	PRELIMINARY	MAR. 19/10

All plans, sketches, drawings, graphic representations and specifications prepared by David Norman Architect Inc. are instruments of service for carrying out a project. David Norman Architect Inc. retains copyright in these plans, sketches, drawings, graphic representations and specifications, which may not be used for any other project without the written consent of David Norman Architect Inc.

Examine the drawings carefully before commencing the Work. Report discrepancies, if any, to the Architect and obtain clarification or additional instructions before proceeding with that part of the Work.

Do not commence the Work unless the drawing is issued for Construction

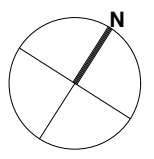

PROJECT:

**QUEENSBOROUGH
COMMUNITY CENTRE
SCHEMATIC
DESIGN STUDY**
920 EWEN AVE.
NEW WESTMINSTER, B.C.

DRAWING:

**AREA
CALCULATIONS**

DRAWN BY: S.C.	CHECKED BY:
DATE: FEB. 25, 2010	SCALE: 1" = 30'-0"
PROJECT NO.: 2922	DRAWING NO.:

SK 1.1
R3